

穴用C型止め輪(スナップリング)【JIS B 2804】

HASHIMA

単位:mm

呼び径	止 め 輪 寸 法						最小					
	d_3		t		b	a						
	寸法	公差	寸法	公差	約	約						
R-	42	45.5	±0.4	1.75	±0.07	4.0	5.8	2.5				
	45	48.5							4.5	5.9		
	47	50.5							4.5	6.1		
	48	51.5							4.5	6.2		
	52	56.2							5.1	6.5		
	55	59.2		±0.45		2.0			5.1	6.5		
	56	60.2								5.1	6.6	
	58	62.2								5.5	6.8	
	60	64.2								5.5	6.8	
	62	66.2								5.5	6.9	
	63	67.2	±0.55		2.5		5.5	6.9	3.0			
	65	69.2						5.5		7.0		
	68	72.5						6.0		7.4		
	70	74.5						6.0		7.4		
	72	76.5						6.6		7.4		
	75	79.5		±0.65	±0.08		6.6	7.8		4.0		
	78	82.5						6.6			8.0	
	80	85.5						7.0			8.0	
	82	87.5						7.0			8.0	
	85	90.5						7.0			8.0	
	88	93.5	±0.55		3.0		7.6	8.2	3.0			
	90	95.5						7.6			8.3	
	92	97.5						8.0			8.3	
	95	100.5						8.0			8.5	
	98	103.5						8.3			8.7	
	100	105.5		±0.65	3.0		8.3	8.8		4.0		
	102	108.0						8.9			9.0	
	105	112.0						8.9			9.1	
	108	115.0						8.9			9.5	
	110	117.0						8.9			10.2	
	112	119.0	+ 1.26 - 0.63		±0.09		8.9	10.2	4.0			
	115	122.0						9.5			10.2	
	120	127.0						9.5			10.7	
	125	132.0						10.0			10.7	
	130	137.0						10.0			10.7	
	135	142.0		+ 1.44 - 0.72	4.0		10.8	11.0		4.0		
	140	147.0						10.8			11.0	
	145	152.0						10.8			11.0	
	150	158.0						11.5			11.8	
	155	164.0						11.5			11.8	
	160	169.0	+ 1.62 - 0.82		5.0		12.0	12.5	4.0			
	165	174.5						12.0			12.7	
	170	179.5						12.0				
	175	184.5						12.3				
	180	189.5						13.0				
	185	194.5		±0.15	5.0		13.5			4.0		
	190	199.5						13.5				
	195	204.5						13.5				
	200	209.5						14.0				
	205	217.0						14.0				
	210	222.0	±0.15		5.0		14.0		4.0			
	215	227.0						14.0				
	220	232.0						14.0				
	225	237.0						14.0				
	230	242.0						14.0				
	235	247.0		±0.15	5.0		14.0			4.0		
	240	252.0						14.0				
	245	257.0						14.0				
	250	262.0						14.0				
	260	275.0						16.0				
	270	285.0					16.0					
	280	295.0			16.0							
	290	305.0			16.0							
	300	315.0			16.0							

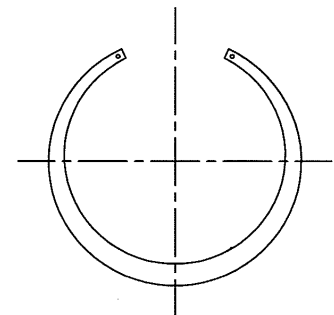
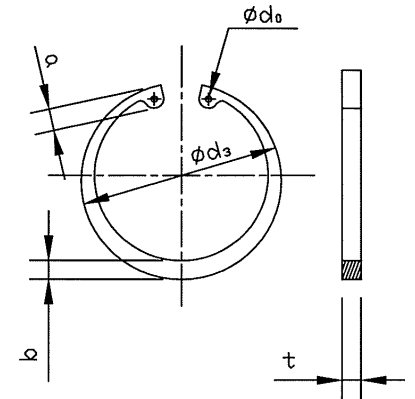

呼び径170 mm以上